

OPTICAL (TGG TYPE) ISOLATOR CORE: POLARIZATION-DEPENDENT
(532, 650, 780, 850, 980, 1030, 1053, 1064nm)

Specifications

Contact Ascentta with your custom specification needs.

Parameter	Unit	532nm	650nm	780nm	850nm	980nm	1030nm	1053nm	1064nm	
Bandwidth	nm	±5								
Isolation (λ_c , 23°C)	Peak	dB	35	35	35	35	35	35	35	35
	Min	dB	30	30	30	30	30	30	30	30
Insertion Loss (23°C)	Typ.	dB	0.45	0.45	0.35	0.35	0.25	0.25	0.25	0.25
	Max	dB	0.60	0.60	0.50	0.50	0.40	0.40	0.40	0.40
Extinction Ratio	Min	dB	28	28	28	28	28	28	28	28
Package Dimension	Cylinder	mm	Φ16xL20	Φ16xL20	Φ16xL30	Φ16xL30	Φ19xL45	Φ19xL45	Φ19xL45	Φ19xL45
Operation Temperature	°C	10 to 50								
Storage Temperature	°C	0 to 60								

Ordering Information

Contact Ascentta with your custom configuration needs.

VIC	Type	Wavelength	Clear Aperture	Max. Power	Diameter* (Φ)	Length* (L)
VIC	PDC=Pol-Dependent with PBS Cube	532=532nm 650=650nm 780=780nm	10=1.0mm 18=1.8mm 24=2..4mm	03=0.3W 10=1.0W 50=5.0W	16=16mm 19=19mm	20=20mm 30=30mm 45=45mm
	PDP=Pol-Dependent with Polarcor	850=850nm 980=980nm 1030=1030nm 1053=1053nm 1064=1064nm X=Others	X=Others	X=Others	X=Others	X=Others

* Refer to diagram. Contact us for: custom specifications, accurate dimensions, and other questions.

Package Dimensions

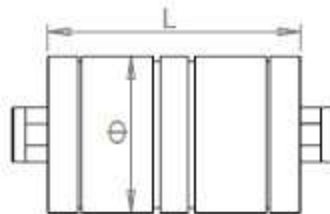

Note: Dot indicates input end transmission orientation.

Contact Ascentta for all your custom design needs.